

Übergangswinkel 90° A.G.

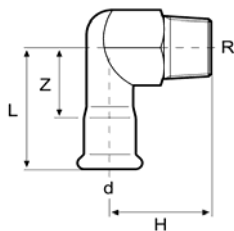

d - R	L	H	Z	Gewicht in g
12-R $\frac{1}{2}$				<i>bald verfügbar</i>
15-R $\frac{1}{2}$	53	36	32	91
15-R $\frac{3}{4}$	62	38	41	137
18-R $\frac{1}{2}$	51	36	30	98
18-R $\frac{3}{4}$	67	37	46	143
22-R $\frac{3}{4}$	58	40	35	145
28-R1	63	44	39	245
35-R1 $\frac{1}{4}$	71	48	44	338
42-R1 $\frac{1}{2}$	81	53	49	425
54-R2	92	59	55	716