

OT 2100 Barrel nipples

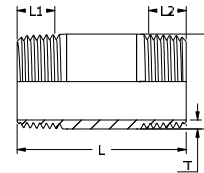

DN	Dim.	L	L1 ISO 7/1	L2 ISO 7/1	D	T	Design pressure Mpa	Weight kg/pce	Article code BSP-threaded EN 1.4404	Article code NPT-threaded EN 1.4404
6	1/8"	40	6	6	10.2	2.0	10	0.02	11-0210-01	11-0210-51
8	1/4"	40	9	9	13.5	2.3	10	0.02	11-0210-02	11-0210-52
10	3/8"	40	9	9	17.2	2.3	10	0.03	11-0210-03	11-0210-53
15	1/2"	60	12	12	21.3	2.6	10	0.07	11-0210-04	11-0210-54
20	3/4"	60	13	13	26.9	2.6	10	0.07	11-0210-05	11-0210-55
25	1"	60	15	15	33.7	3.2	10	0.12	11-0210-06	11-0210-56
32	1 1/4"	80	17	17	42.4	3.2	6.4	0.21	11-0210-07	11-0210-57
40	1 1/2"	80	17	17	48.3	3.2	6.4	0.24	11-0210-08	11-0210-58
50	2"	100	22	22	60.3	3.6	6.4	0.42	11-0210-09	11-0210-59
65	2 1/2"	100	24	24	76.1	3.6	4	0.53	11-0210-10	-
80	3"	120	27	27	88.9	4.0	4	0.76	11-0210-11	-
100	4"	150	33	33	114.3	4.0	4	1.30	11-0210-12	-