

OT 2170
Hexagonal nuts

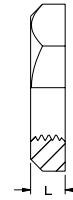

DN	Dim.	L ISO 228/1	NW	Design pressure Mpa	Weight kg/pce	Article code EN 1.4404
6	1/8"	7	17	10.0	0.01	11-0217-01
8	1/4"	8	22	10.0	0.02	11-0217-22
10	3/8"	9	27	10.0	0.03	11-0217-23
15	1/2"	9	32	10.0	0.04	11-0217-24
20	3/4"	10	36	10.0	0.05	11-0217-25
25	1"	11	46	10.0	0.08	11-0217-26
32	1 1/4"	13	55	6.4	0.13	11-0217-07
40	1 1/2"	13	60	6.4	0.13	11-0217-08
50	2"	14	75	6.4	0.22	11-0217-09
65	2 1/2"	16	95	4.0	0.40	11-0217-10
80	3"	19	105	4.0	0.48	11-0217-11